

With its heavy-duty cast-iron construction and fast priming capabilities, this solids handling trailer mounted jet pump leads the industry in construction, industrial and mining applications. The Thompson 6JSCEE-DIST-4LE2T-M is designed for high flows to 2450 gpm and heads to 120 feet making it perfect for sewage bypass pumping or general construction dewatering

ENVIROPRIME SYSTEM[®] with Compressor

- Thompson's innovative priming system preventing blow-by of sewage, effluent and waste from discharging onto the ground. This system, with Thompson's compressor priming system, offers mid-range air handling capabilities for quick priming.



Consult factory for other versions & options including site trailers, sound attenuation, etc.

<i>Materials</i>	
Pump Casing	65-45-12 ductile iron, tangential discharge, clockwise rotation, back pullout design
Impeller	65-45-12 ductile iron*, closed or semi-open, 2-vane, 3" solids handling, balanced and contains rear equalizing vanes, 9.5" diameter
Mechanical Seal	Grease or oil lubricated single component type with Tungsten Carbide vs Silicon Car-bide faces with Viton elastomers
Shaft	Modified SAE 1144 "stress-proof" steel
Bearings & Frame	Grease or oil lubricated, 6316 deep groove ball bearings. Class 30 Cast Iron with cooling fins and mounting tabs

TECHNICAL SPECIFICATIONS

Suction Size	6 in (15.24 cm)	Approximate Dry Weight	4,100 lbs (1859.73 kg)
Discharge Size	6 in (15.24 cm)	Fuel Tank	100 gal (378.54 L)
Maximum Flow Capacity	2450 gpm (556.15 m ³ /h)	Fuel Consumption @ 2000 rpm	2.88 gph (10.9 L/h)
Maximum Head	120 ft (36.58 m)	Best Efficiency Point	80 %
Maximum Solids Handling	3 in (7.62 cm)	Maximum Operating Times	Fuel Economy
Maximum Operating Speed	2000 rpm	34 hours @ 2000 rpm	0.396 lb/hp-hr @ 2000 rpm
Maximum Operating Temp.	200 °F (93.33 °C)	44 hours @ 1800 rpm	0.386 lb/hp-hr @ 1800 rpm
Maximum Operating Pressure	51.9 psi (358.17 kPa)	58 hours @ 1600 rpm	0.372 lb/hp-hr @ 1600 rpm

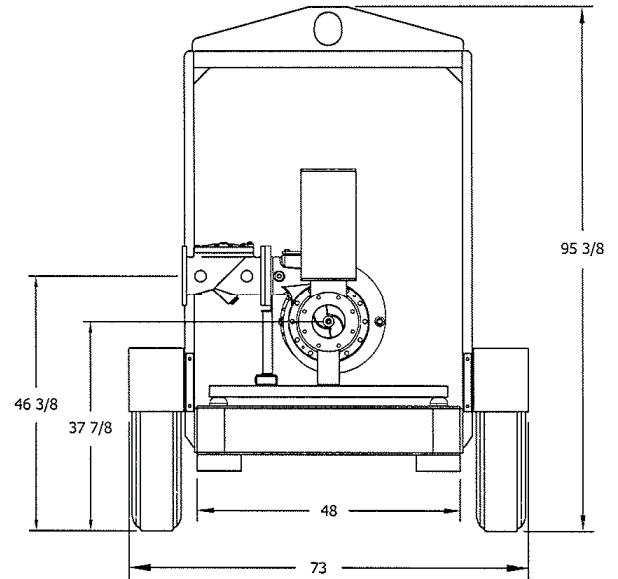
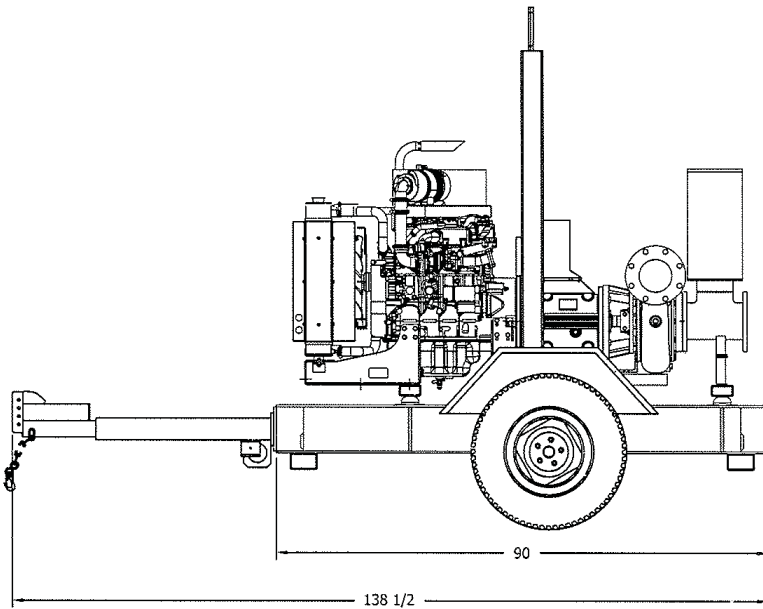
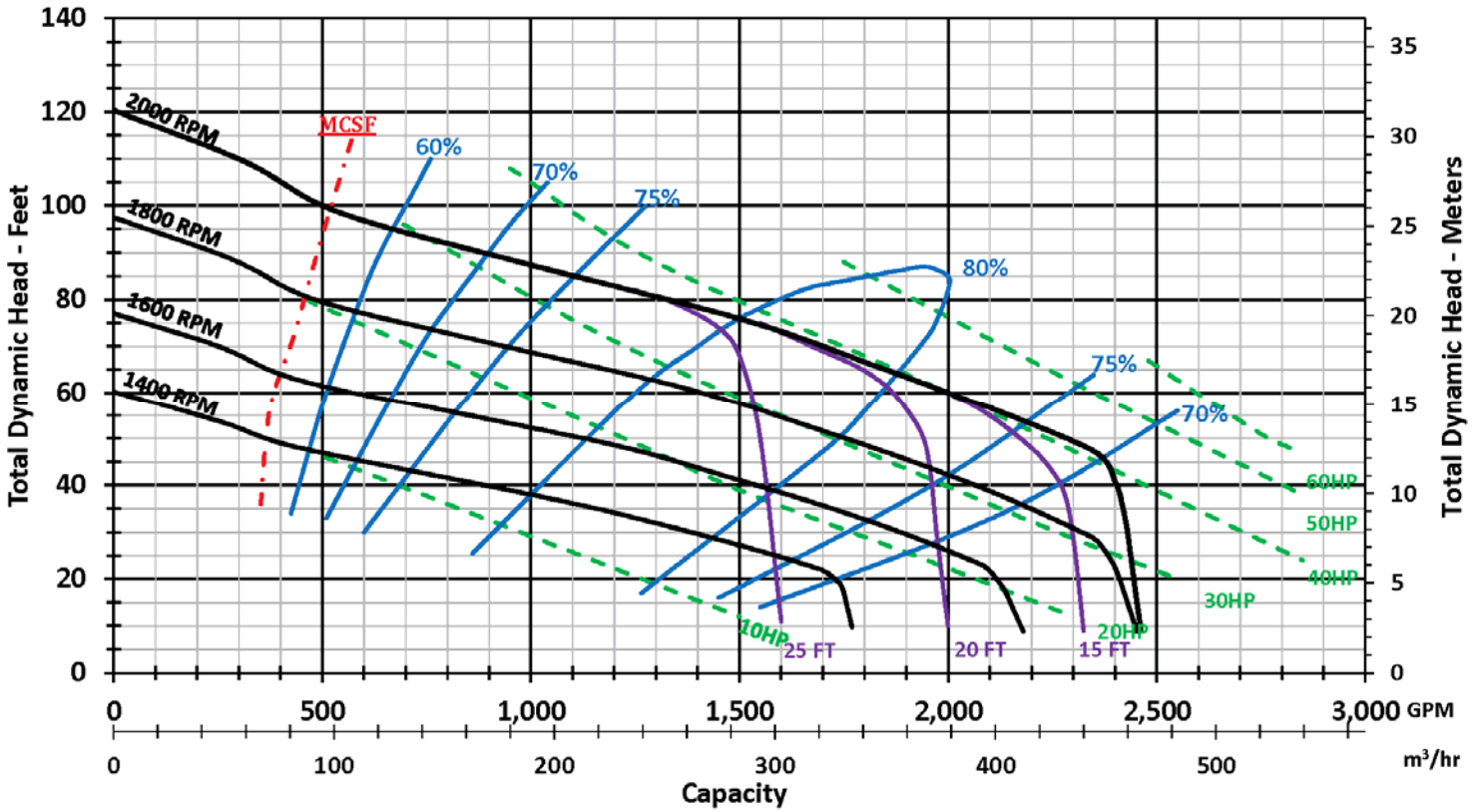

Engine Specification

Engine Model	Isuzu 4LE2T 40 HP @ 1800 rpm	Standard Equipment	Cooled EGR, Wastegate Turbocharger, emission control device, alternator, radiator
Type	EPA Final Tier 4, In-Line, 4-Cycle, Turbocharged, high-pressure common-rail diesel	Automatic Shutdowns	Low lube oil pressure; high water temperature

Specifications and illustrations are subject to revision without notice and without incurring any obligation for previous or subsequent equipment sold. Thompson Pump (ISO 9001:2008) makes no representation regarding the completeness or accuracy of this information and is not liable for any direct or indirect damages arising from or relating to this information or its use. Capacity & Head are shown for comparative purposes. Consult Thompson factory for exact capabilities.